

Z23 ■ These assemblies must comply with workmanship standards IPC-A-610 Class 2, unless otherwise specified.

Z22 ■ These assemblies must be clean and free from flux and all contaminants. Use of no clean flux is not acceptable.

Z21 ■ These assemblies are ESD sensitive, ESD precautions shall be observed.

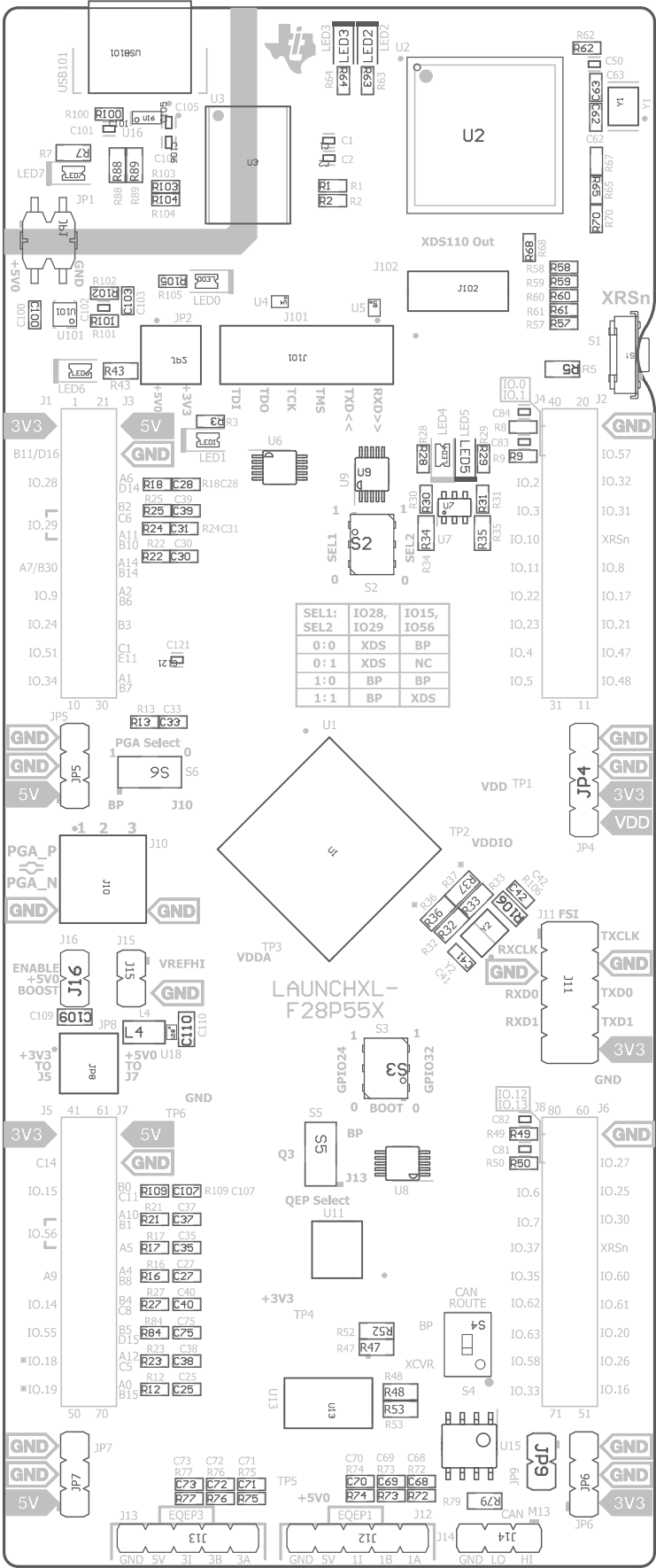

COMPONENTS MARKED 'DNP' SHOULD NOT BE POPULATED.  
ASSEMBLY VARIANT: [No Variations]

PCB VIEWED FROM TOP SIDE	BOARD #: MCU133	REV: C	SUN REV: Not in version control
M5p Assembly Top	TID #: N/A		
PLOT NAME = Top Assembly Drawing	GENERATED : 5/30/2025 6:57:59 PM	TEXAS INSTRUMENTS	

